



Quality
Cabinetry

contents

Cabinet Features	03	Single Series	04
-Lumber Quality	07	-Key Largo White	04
-Finish	07	-Colorado White Shaker	04
-Corner Support	07	-Summit Shaker	04
-Assembly Method	08	Shaker Series	05
-Inside Finish	08	-White Shaker Elite	05
-Soft Close Hinge	09	-Grey Shaker Elite	05
-Soft Close Glides	09	-Navy Blue Shaker	05
-Life Time Warranty	09	-Shaker Espresso	05
		-Shaker Cinnamon	05
		York Series	05
Wall Cabinet Specifications	08-10	-York Driftwood Grey	05
		-York Linen	05
Base Cabinet Specifications	10-11	-York Saddle	05
		Charleston Series -	06
Tall Cabinet Specifications	11	Charleston Linen -	06
		Charleston Saddle -	06
Accessory Cabinet Specifications	12-13	Charleston Cherry -	06
		Charleston Toffee	06
Trim Specifications	13-14	Madison Series	06
		-Madison Chocolate -	06
Vanity Cabinet Specifications	14-15	Madison Toffee	06
		Bristol Series	07
Vent Hood Specifications	15-16	-Bristol Linen	07
		Craftsman Series	07
Cabinet Insert Specifications	16-19	-White Craftsman	07
		-Lily Green Craftsman	07
Floating Shelf Specifications	19		

Cabinet Features



lumber quality

We believe quality cabinets begin with quality materials. We proudly source top-grade lumber for dependable quality assurance and long lasting beauty.



finish

To top off our solid wood cabinets, we apply an extensive 7- step finishing process to ensure their beauty lasts a lifetime. The doors and face-frames are hand finished with expert precision to create a smooth, premium quality finish.



corner support

To ensure the highest structural integrity of our cabinets, we use wood and metal corner supports. These structural elements help to maintain squareness throughout the installation process and the lifetime of the cabinet.



assembly method

Our dovetail cabinet construction process uniquely interlocks all components ensuring a strong cabinet that can stand the test of time. We also offer a metal clip assembly method that is standard to the RTA cabinet industry.

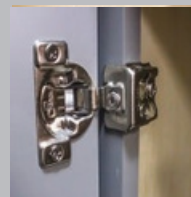

soft-close

Our premium 6-way adjustable soft-closing hinges are included with most of most cabinet styles. These compact soft-closing hinges ensure your cabinet doors shut smoothly and quietly, eliminating harsh slamming and preserving the integrity of the cabinet.

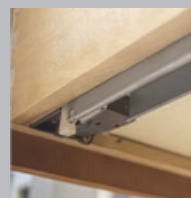

soft close glides

An enhanced feature included with most of our cabinets is our premium drawer glides that soft-close with a small push. The full extension drawer glides also allow you to maximize storage and access the full depth of the drawer.

single series

KEY LARGO WHITE

Door Style: Full Overlay, Raised Panel (Full Engineered Door)
Box Construction: 1/2" Solid Plywood (Birch/Poplar)
Drawer Glide: Full Extension, Soft Close Under-Mount
Drawer: 5-Piece, Full Engineered Drawer Head (Matches Door)
Drawer Construction: 5/8" Solid Wood, Dovetail Construction
Hinge: Soft Close Adjustable
Interior Finish: Natural UV Coated
Cabinet Exterior: Matching Door Finish
Assembly Method: Metal Clip



COLORADO WHITE SHAKER

Door Style: Full Overlay, Flat Panel (Full Engineered Door)
Box Construction: 1/2" Solid Plywood (Birch/Poplar)
Drawer Glide: Full Extension, Soft Close Under-Mount
Drawer Head: 5-Piece, Full Engineered Drawer Head (Matches Door)
Drawer Construction: 5/8" Solid Wood, Dovetail Construction
Hinge: Soft Close Adjustable
Cabinet Interior: Natural UV Coated
Cabinet Exterior: Matching Door Finish
Assembly Method: Dovetail



SUMMIT SHAKER WHITE

Door Style: Partial Overlay, Flat Panel (Full Engineered Door)
Box Construction: 1/2" Solid Plywood (Birch/Poplar)
Drawer Glide: 3/4 Extension, Steel Epoxy Under-Mount
Drawer: 5-Piece, Full Engineered Drawer Head (Matches Door)
Drawer Construction: 5/8" Solid Wood, Dovetail Construction
Hinge: Soft Close Adjustable
Interior Finish: Natural Laminate
Cabinet Exterior: White Laminate
Assembly Method: Metal Clip



shaker series

Door Style: Full Overlay, Flat Panel (Full Engineered Door)

Box Construction: 1/2" Solid Plywood (Birch/Poplar)

Drawer Glide: Full Extension, Soft Close Under-Mount

Hinge: Soft Close Adjustable

Cabinet Interior: Natural UV Coated

Cabinet Exterior: Matching Door Finish

Drawer Head: 5-Piece, Full Engineered Drawer Head (Matches Door)

Drawer Construction: 5/8" Solid Wood, Dovetail Construction

Assembly Method: Dovetail

SHAKER CINNAMON

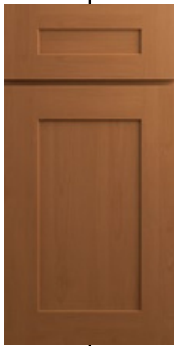

NAVY BLUE SHAKER

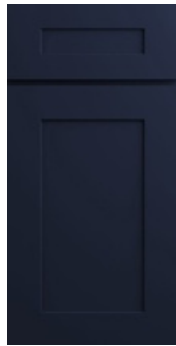

WHITE SHAKER ELITE

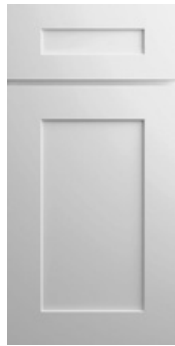

GREY SHAKER ELITE



SHAKER ESPRESSO



york series

Door Style: Full Overlay, Flat Panel with Glaze (Engineered Center Panel)

Box Construction: 1/2" Solid Plywood (Birch/Poplar)

Drawer Glide: Full Extension, Soft Close Under-Mount

Hinge: Soft Close Adjustable

Cabinet Interior: Natural UV Coated

Cabinet Exterior: Matching Door Finish

Drawer Head: 5-Piece, Engineered Center Panel (Matches Door)

Drawer Construction: 5/8" Solid Wood, Dovetail Construction

Assembly Method: Dovetail

YORK DRIFTWOOD GREY



YORK SADDLE

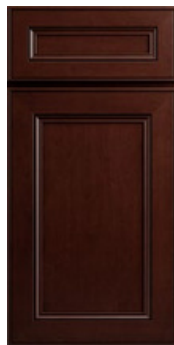

YORK LINEN



charleston series

Door Style: Solid Wood Full Overlay, Raised Panel with Glazing
Box Construction: 1/2" Solid Plywood (Birch/Poplar)
Drawer Glide: Full Extension, Soft Close Under-Mount

Hinge: Soft Close Adjustable
Cabinet Interior: Natural UV Coated
Cabinet Exterior: Matching Door Finish

Drawer Head: Solid Wood, 5-Piece (Matches Door)
Drawer Construction: 5/8" Solid Wood, Dovetail Construction
Assembly Method: Dovetail

CHARLESTON TOFFEE



CHARLESTON SADDLE

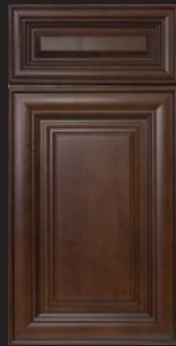

CHARLESTON LINEN



CHARLESTON CHERRY

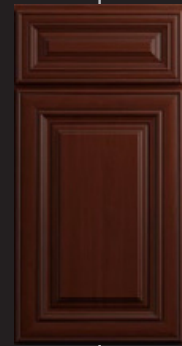

madison series

Door Style: Full Overlay, Raised Panel with Glazing (Engineered Center Panel)
Box Construction: 1/2" Solid Plywood (Birch/Poplar)
Drawer Glide: Side-Mount Epoxy

Hinge: 6-way Adjustable, Concealed Cup Hinge
Cabinet Interior: Natural UV Coated
Cabinet Exterior: Matching Door Finish

Drawer Head: 5-Piece, Engineered Center Panel (Matches Door)
Drawer Construction: 5/8" Solid Wood, Dovetail Construction
Assembly Method: Metal Clip

MADISON CHOCOLATE

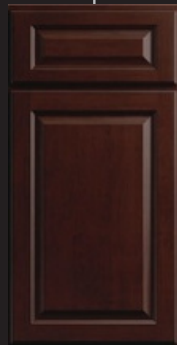

MADISON TOFFEE



bristol series

Door Style: Solid Wood Full Overlay, Raised Panel with Glazing

Box Construction: 1/2" Solid Plywood (Birch/Poplar)

Drawer Glide: Full Extension, Soft Close Under-Mount

Hinge: Soft Close Adjustable

Cabinet Interior: Natural UV Coated

Cabinet Exterior: Matching Door Finish

Drawer Head: Solid Wood, 5-Piece (Matches Door)

Drawer Construction: 5/8" Solid Wood, Dovetail Construction

Assembly Method: Dovetail

BRISTOL LINEN



CRAFTSMAN SHAKER

CRAFTSMAN LILY
GREEN SHAKER



CRAFTSMAN
WHITE SHAKER



wall cabinet specification

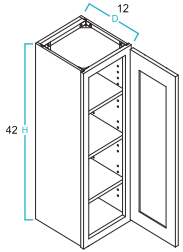

High Single Door Wall Cabinets							
SKU	Cabinet Box			Cabinet Doors			
	W	H	D	W	H	D	
W0942	9	42	12	8 1/2	41	7/8	
W1242	12	42	12	11 1/2	41	7/8	
W1542	15	42	12	14 1/2	41	7/8	
W1842	18	42	12	17 1/2	41	7/8	
W2142	21	42	12	20 1/2	41	7/8	

*All single door cabinets may be left or right swing.

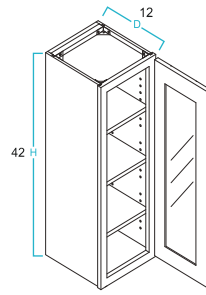

High Single Glass Door Wall Cabinets							
SKU	Cabinet Box			Cabinet Doors			
	W	H	D	W	H	D	
WM1542GDFI	15	42	12	14 1/2	41	7/8	
WM1842GDFI	18	42	12	17 1/2	41	7/8	

*All single door cabinets may be left or right swing. Finished interior, glass included. Mullion bars on Charleston Series only. (excluding Charleston Antique White and Charleston Linen)

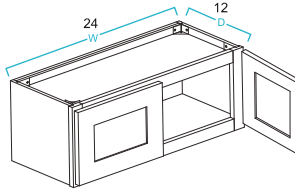

24" Wide Double Door Bridge Wall Cabinets							
SKU	Cabinet Box			Cabinet Doors			
	W	H	D	W	H	D	
W2415	24	15	12	11 3/4	14	7/8	
W2418	24	18	12	11 3/4	17	7/8	
W2424	24	24	12	11 3/4	23	7/8	

*24" tall cabinets have one shelf.

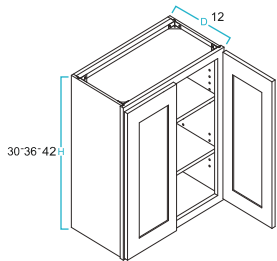

30/36/42" High Double Door Wall Cabinets							
SKU	Cabinet Box			Cabinet Doors			
	W	H	D	W	H	D	
W2430	24	30	12	11 3/4	29	7/8	
W2730	27	30	12	13 1/4	29	7/8	
W3030	30	30	12	14 5/8	29	7/8	
W3330	33	30	12	16 1/4	29	7/8	
W3630	36	30	12	17 3/4	29	7/8	
W3930	39	30	12	19	29	7/8	
W2436	24	36	12	11 3/4	35	7/8	
W2736	27	36	12	13 1/4	35	7/8	
W3036	30	36	12	14 5/8	35	7/8	
W3336	33	36	12	16 1/4	35	7/8	
W3636	36	36	12	17 3/4	35	7/8	
W3936	39	36	12	19	35	7/8	
W2442	24	42	12	11 3/4	41	7/8	
W2742	27	42	12	13 1/4	41	7/8	
W3042	30	42	12	14 5/8	41	7/8	
W3342	33	42	12	16 1/4	41	7/8	
W3642	36	42	12	17 3/4	41	7/8	
W3942	39	42	12	19	41	7/8	

*39" only has center stile.

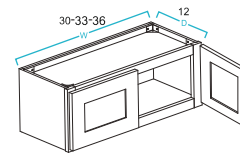

*24" tall cabinets have one shelf.

30/33/36" Wide Double Door Bridge Wall Cabinets							
SKU	Cabinet Box			Cabinet Doors			
	W	H	D	W	H	D	
W3012	30	12	12	14 5/8	11	7/8	
W3015	30	15	12	14 5/8	14	7/8	
W3018	30	18	12	14 5/8	17	7/8	
W3024	30	24	12	14 5/8	23	7/8	
W3312	33	12	12	14 5/8	11	7/8	
W3315	33	15	12	14 5/8	14	7/8	
W3318	33	18	12	14 5/8	17	7/8	
W3324	33	24	12	14 5/8	23	7/8	
W3612	36	12	12	17 3/4	11	7/8	
W3615	36	15	12	17 3/4	14	7/8	
W3618	36	18	12	17 3/4	17	7/8	
W3624	36	24	12	17 3/4	23	7/8	

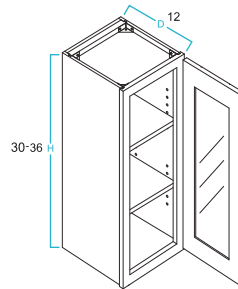

30/36" High Single Glass Door Wall Cabinets							
SKU	Cabinet Box			Cabinet Doors			
	W	H	D	W	H	D	
WM1530GDFI	15	30	12	14 1/2	29	7/8	
WM1830GDFI	18	30	12	17 1/2	29	7/8	
WM1536GDFI	15	36	12	14 1/2	35	7/8	
WM1836GDFI	18	36	12	17 1/2	35	7/8	

*All single door cabinets may be left or right swing. Finished interior, glass included. Mullion bars on Charleston Series only. (excluding Charleston Antique White and Charleston Linen)

30/36" High Single Door Wall Cabinets							
SKU	Cabinet Box			Cabinet Doors			
	W	H	D	W	H	D	
W0930	9	30	12	8 1/2	29	7/8	
W1230	12	30	12	11 1/2	29	7/8	
W1530	15	30	12	14 1/2	29	7/8	
W1830	18	30	12	17 1/2	29	7/8	
W2130	21	30	12	20 1/2	29	7/8	
W0936	9	36	12	8 1/2	35	7/8	
W1236	12	36	12	11 1/2	35	7/8	
W1536	15	36	12	14 1/2	35	7/8	
W1836	18	36	12	17 1/2	35	7/8	
W2136	21	36	12	20 1/2	35	7/8	

*All single door cabinets may be left or right swing.

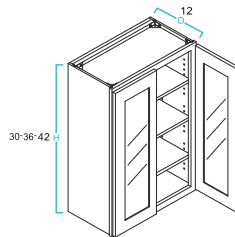

*Finished interior, glass included. Mullion bars on Charleston Series only. (excluding Charleston Antique White and Charleston Linen)

30/36/42" High Double Glass Door Wall Cabinets							
SKU	Cabinet Box			Cabinet Doors			
	W	H	D	W	H	D	
W2430	24	30	12	11 3/4	29	7/8	
W3030	30	30	12	14 5/8	29	7/8	
W3630	36	30	12	17 3/4	29	7/8	
W2436	24	36	12	11 3/4	35	7/8	
W3036	30	36	12	14 5/8	35	7/8	
W3636	36	36	12	17 3/4	35	7/8	
W2442	24	42	12	11 3/4	41	7/8	
W3042	30	42	12	14 5/8	41	7/8	
W3642	36	42	12	17 3/4	41	7/8	

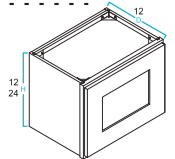

12/24" High Single Door Bridge Wall Cabinets							
SKU	Cabinet Box			Cabinet Doors			
	W	H	D	W	H	D	
W1812	18	12	12	17 1/2	11	7/8	
W2112	21	12	12	20 1/2	11	7/8	
W2124	21	24	12	20 1/2	23	7/8	

*All single door cabinets can be left or right swing. 24" tall cabinets have one shelf.

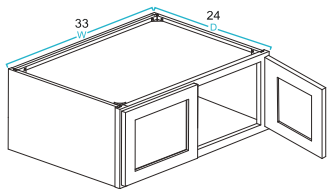

33" Wide Refrigerator Wall Cabinets							
SKU	Cabinet Box			Cabinet Doors			
	W	H	D	W	H	D	
W331224	33	12	24	16 1/4	11	7/8	
W331824	33	18	24	16 1/4	17	7/8	
W332424	33	24	24	16 1/4	23	7/8	

*24" tall cabinets have one shelf.

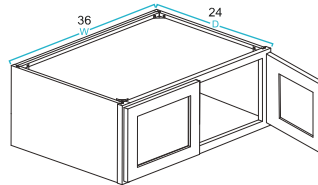

36" Wide Refrigerator Wall Cabinets							
SKU	Cabinet Box			Cabinet Doors			
	W	H	D	W	H	D	
W361224	36	12	24	17 3/4	11	7/8	
W361524	36	15	24	17 3/4	14	7/8	
W361824	36	18	24	17 3/4	17	7/8	
W362424	36	24	24	17 3/4	23	7/8	

*24" tall cabinets have one shelf.

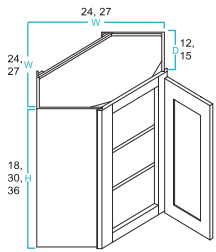

18 - 36" Diagonal Corner Wall Cabinets							
SKU	Cabinet Box			Cabinet Doors			
	W	H	D	W	H	D	
WDC2418	24	18	12	15	17	7/8	
WDC2430	24	30	12	15	29	7/8	
WDC2436	24	36	12	15	35	7/8	
WDC273615	27	36	15	15	35	7/8	

*All single door cabinets may be left or right swing. WDC2418 has no shelf.

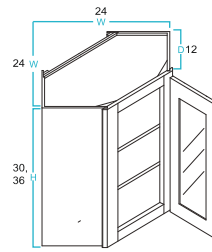

30 - 36" Diagonal Corner Glass Wall Cabinets							
SKU	Cabinet Box			Cabinet Doors			
	W	H	D	W	H	D	
WMDC2430GDFI	24	30	12	15	39	7/8	
WMDC2436GDFI	24	36	12	15	35	7/8	

*All single door cabinets may be left or right swing. Finished interior, glass included. Mullion bars on Charleston Series only. (excluding Charleston Antique White and Charleston Linen)

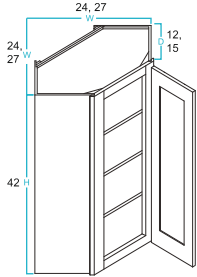

42" Diagonal Corner Wall Cabinets							
SKU	Cabinet Box			Cabinet Doors			
	W	H	D	W	H	D	
WDC2442	24	42	12	15	41	7/8	
WDC274215	27	42	12	15	41	7/8	

*All single door cabinets may be left or right swing.

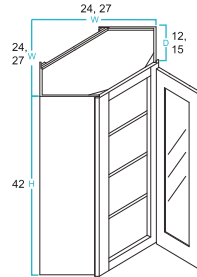

42" Diagonal Corner Glass Wall Cabinets							
SKU	Cabinet Box			Cabinet Doors			
	W	H	D	W	H	D	
WMDC2442GDFI	24	30	12	15	39	7/8	
WMDC274215GDFI	24	36	12	15	35	7/8	

*All single door cabinets may be left or right swing. Finished interior, glass included. Mullion bars on Charleston Series only. (excluding Charleston Antique White and Charleston Linen)

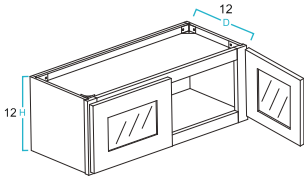

12" High Double Door Glass Wall Cabinet							
SKU	Cabinet Box			Cabinet Doors			
	W	H	D	W	H	D	
W2412BGFI	24	12	12	11 3/4	11	7/8	
W2712BGFI	27	12	12	13 3/4	11	7/8	
W3012BGFI	30	12	12	14 1/4	11	7/8	
W3312BGFI	33	12	12	16 1/4	11	7/8	
W3612BGFI	36	12	12	17 3/4	11	7/8	

*Finished interior, glass included.

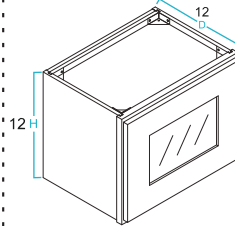

12" High Single Door Glass Wall Cabinet							
SKU	Cabinet Box			Cabinet Doors			
	W	H	D	W	H	D	
W1212BGFI	12	12	12	11 1/2	11	7/8	
W1512BGFI	15	12	12	14 1/2	11	7/8	
W1812BGFI	18	12	12	17 1/2	11	7/8	
W2112BGFI	21	12	12	20 1/2	11	7/8	

*All single door cabinets may be left or right swing. Finished interior, glass included.

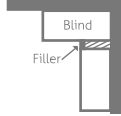
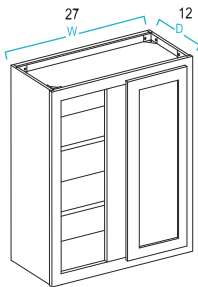

Blind Corner Wall Cabinets							
SKU	Cabinet Box			Cabinet Doors			
	W	H	D	W	H	D	
BLW2730	27	30	12	11 1/2	29	7/8	
BLW2736	27	36	12	11 1/2	35	7/8	
BLW2742	27	42	12	11 1/2	41	7/8	

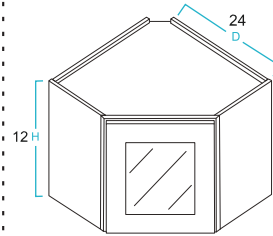

12" High Single Door Glass Corner Cabinet							
SKU	Cabinet Box			Cabinet Doors			
	W	H	D	W	H	D	
WDC2412BGFI	24	12	12	11	15	7/8	

*All single door cabinets may be left or right swing. Finished interior, glass included.

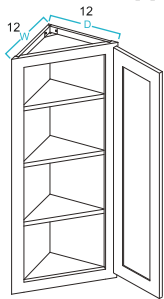

High Angle Wall Cabinets							
SKU	Cabinet Box			Cabinet Doors			
	W	H	D	W	H	D	
AW1230	12	30	12	15 1/4	29	7/8	
AW1236	12	36	12	15 1/4	35	7/8	
AW1242	12	42	12	15 1/4	41	7/8	

*All single door cabinets can be left or right swing.

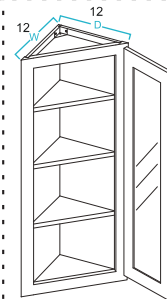

High Angle Glass Wall Cabinets							
SKU	Cabinet Box			Cabinet Doors			
	W	H	D	W	H	D	
WMDAW1230	12	30	12	15 1/4	29	7/8	
WMDAW1236	12	36	12	15 1/4	35	7/8	
WMDAW1242	12	42	12	15 1/4	41	7/8	

*All single door cabinets can be left or right swing.

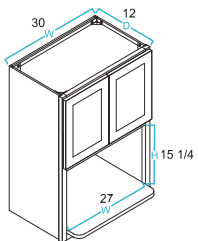

30" Wide Microwave Oven Cabinets							
SKU	Cabinet Box			Cabinet Doors			
	W	H	D	W	H	D	
MO3030	30	30	12	14 5/8	10 1/2	7/8	
MO3036	30	36	12	14 5/8	16 1/2	7/8	
MO3042	30	42	12	14 5/8	22 1/2	7/8	

*Opening dimension is 27" x 15 1/4". Shelf is 18" deep.

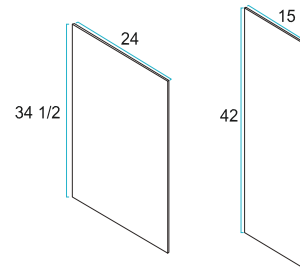

Base and Wall Skins			
SKU	Dimensions		
	W	H	D
BS24	24	34 1/2	1/4
WS24	15	42	1/4

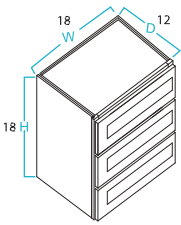

18" Wide/High Wall Drawer Cabinet									
SKU	Cabinet Box			Drawer Head			Drawer Boxes		
	W	H	D	W	H	D	W	H	D
WD1818	18	18	12	17 1/2	5 3/8	7/8	14	3	10

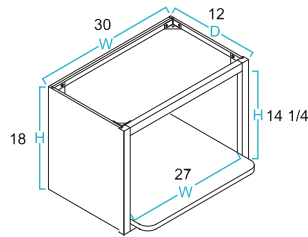

30" Wide Wall Microwave Cabinet						
SKU	Cabinet Box			Cabinet Doors		
	W	H	D	W	H	D
MS3018	30	18	12	N/A	N/A	N/A

*Opening dimension is 27" x 14 1/4". Shelf is 18" deep.

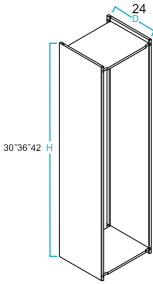

Depth Wall Modification Kits	
WKIT30	
WKIT36	
WKIT42	

*Must be modified by Lily Ann Natural nished interior.

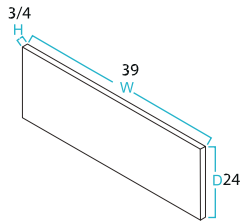

24" Shelf Kit
SKIT24

*Comes with three natural nished shelves.

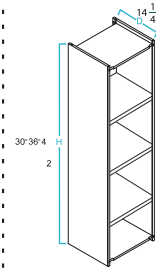

15" Depth Wall Modification Kits	
WKIT3015	
WKIT3615	
WKIT4215	

*Used to increase all standard wall cabinet depth. Shelves included are 15" deep. Natural nished interior.

base cabinet specification

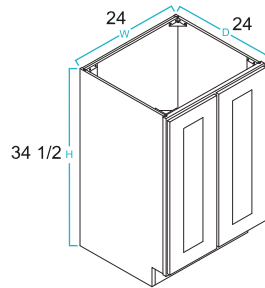

24" Full Height Double Door Base Cabinet						
SKU	Cabinet Box			Cabinet Doors		
	W	H	D	W	H	D
B24FHD	24	34 1/2	24	11 3/4	29 1/4	7/8

*One adjustable shelf.

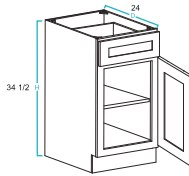

12 - 21" Wide Single Door/Single Drawer Base Cabinets												
SKU	Cabinet Box			Cabinet Doors			Drawer Head			Drawer Box		
	W	H	D	W	H	D	W	H	D	W	H	D
B12	12	34 1/2	24	11 1/2	22	7/8	11 1/2	6 3/4	7/8	8 1/2	4	21
B15	15	34 1/2	24	14 1/2	22	7/8	14 1/2	6 3/4	7/8	11 1/2	4	21
B18	18	34 1/2	24	17 1/2	22	7/8	17 1/2	6 3/4	7/8	14 1/2	4	21
B21	21	34 1/2	24	20 1/2	22	7/8	20 1/2	6 3/4	7/8	17 1/2	4	21

*All single door cabinets may be left or right swing. One adjustable shelf.

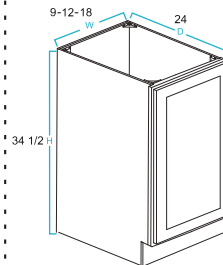

9 - 18" Full Height Single Door Base Cabinets						
SKU	Cabinet Box			Cabinet Doors		
	W	H	D	W	H	D
B9FHD	9	34 1/2	24	8 1/2	29 1/4	7/8
B12FHD	12	34 1/2	24	11 1/2	29 1/4	7/8
B18FHD	18	34 1/2	24	17 1/2	29 1/4	7/8

*All single door cabinets may be left or right swing. One adjustable shelf.

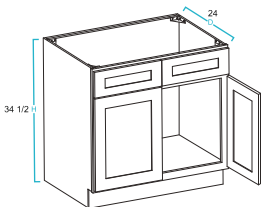

36 - 42" Wide Double Door Sink Base Cabinets									
SKU	Cabinet Box			Cabinet Doors			Drawer Head		
	W	H	D	W	H	D	W	H	D
SB36	36	34 1/2	24	17 3/4	22	7/8	17 3/4	6 3/4	7/8
SB42	42	34 1/2	24	20 1/2	22	7/8	20 1/2	6 3/4	7/8

*SB42 has center stile

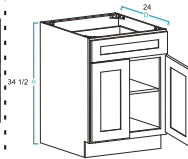

24 - 30" Wide Double Door/Single Drawer Base Cabinets												
SKU	Cabinet Box			Cabinet Doors			Drawer Head			Drawer Box		
	W	H	D	W	H	D	W	H	D	W	H	D
B24	24	34 1/2	24	11 3/4	22	7/8	23 1/2	6 3/4	7/8	20 1/2	4	21
B27	27	34 1/2	24	13 3/4	22	7/8	26 1/2	6 3/4	7/8	23 1/2	4	21
B30	30	34 1/2	24	14 5/8	22	7/8	29 1/2	6 3/4	7/8	26	4	21

*Madison Series B30 cabinets are single drawer, all other series B30 cabinets are double drawer. One adjustable shelf.

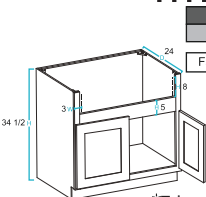

36" Wide Farm Sink Base Cabinet						
SKU	Cabinet Box			Cabinet Doors		
	W	H	D	W	H	D
FSB36	36	34 1/2	24	17 3/4	17 3/4	7/8

*Trimable to accommodate 30-36" wide, 8-11 1/2" tall farm sinks. Additional bracing may be required.

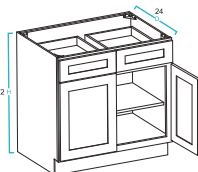

30 - 42" Double Door/Double Drawer Base Cabinets												
SKU	Cabinet Box			Cabinet Doors			Drawer Head			Drawer Box		
	W	H	D	W	H	D	W	H	D	W	H	D
B30	30	34 1/2	24	14 5/8	22	7/8	14 5/8	6 3/4	7/8	11 5/8	4	21
B33	33	34 1/2	24	16 1/4	22	7/8	16 1/4	6 3/4	7/8	13 1/4	4	21
B36	36	34 1/2	24	17 3/4	22	7/8	17 3/4	6 3/4	7/8	14 3/4	4	21
B39	39	34 1/2	24	19	22	7/8	19 1/8	6 3/4	7/8	16	4	21
B42	42	34 1/2	24	20 1/2	22	7/8	20 1/2	6 3/4	7/8	17 1/2	4	21

*B39 and B42 have center stile. One adjustable shelf.

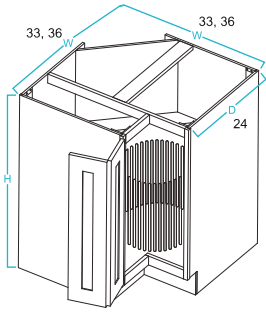

SKU	33 - 36" Lazy Susan Base Cabinets					
	Cabinet Box			Cabinet Doors		
	W	H	D	W	H	D
LS33	33	34 1/2	24	7 3/4	29 1/4	7/8
LS36	36	34 1/2	24	10 3/4	29 1/4	7/8

*Comes with shelf and polymer carousel kit.

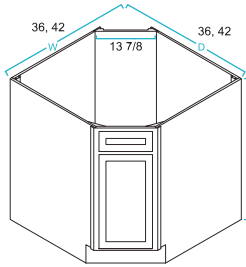

SKU	36 - 42" Corner Sink Bases								
	Cabinet Box			Cabinet Doors			Drawer Head		
	W	H	D	W	H	D	W	H	D
CSB36	36	34 1/2	36	15	22	7/8	15	6 3/4	7/8
CSB42	42	34 1/2	42	23 1/2	22	7/8	23 1/2	6 3/4	7/8

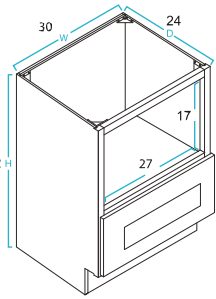

SKU	30" Microwave Base Cabinets								
	Cabinet Box			Drawer Head			Drawer Box		
	W	H	D	W	H	D	W	H	D
MB30	30	34 1/2	24	29 1/2	10 3/4	21	26 1/2	8	7/8

*Fillers can be used to accommodate smaller microwaves.

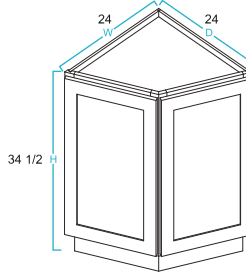

SKU	24" Depth Angle Base Cabinet					
	Cabinet Box			Cabinet Doors		
	W	H	D	W	H	D
AB24	24	34 1/2	24	17 7/8	29 1/4	7/8

SKU	24 - 36" Wide Two Drawer Base Cabinets								
	Cabinet Box			Drawer Head			Drawer Box		
	W	H	D	W	H	D	W	H	D
DB24-2	25	34 1/2	24	23 1/2	14 3/8	7/8	20 1/2	11	21
DB36-2	36	34 1/2	24	35 1/2	14 3/8	7/8	32 1/2	11	21

*Drawer heads are the same size.

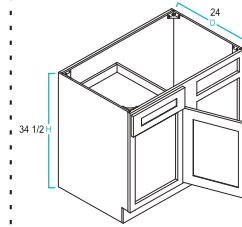
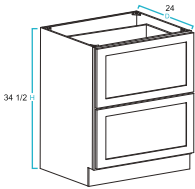

SKU	36/39" - 42/45" Wide Blind Base Corner Cabinets											
	Cabinet Box			Cabinet Doors			Drawer Head			Drawer Box		
	W	H	D	W	H	D	W	H	D	W	H	D
BLB36/39L	36	34 1/2	24	11 1/2	22	7/8	11 1/2	6 3/4	7/8	8 1/2	4	21
BLB36/39R	36	34 1/2	24	11 1/2	22	7/8	11 1/2	6 3/4	7/8	8 1/2	4	21
BLB42/45L	42	34 1/2	24	17 1/2	27	7/8	17 1/2	6 3/4	7/8	14 1/2	4	21
BLB42/45R	42	34 1/2	24	17 1/2	27	7/8	17 1/2	6 3/4	7/8	14 1/2	4	21

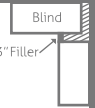

*Bottom drawer heads are same size.

SKU	12 - 36" Wide Three Drawer Base Cabinets					
	Bottom Drawer Heads			Bottom Drawer Boxes		
	W	H	D	W	H	D
DB12-3	11 1/2	10 3/4	7/8	8 1/2	7 1/2	21
DB15-3	14 1/2	10 3/4	7/8	11 1/2	7 1/2	21
DB18-3	17 1/2	10 3/4	7/8	14 1/2	7 1/2	21
DB21-3	20 1/2	10 3/4	7/8	17 1/2	7 1/2	21
DB24-3	23 1/2	10 3/4	7/8	20 1/2	7 1/2	21
DB30-3	29 1/2	10 3/4	7/8	26 1/2	7 1/2	21
DB36-3	35 1/2	10 3/4	7/8	32 1/2	7 1/2	21

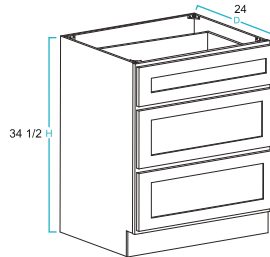

*All blind base cabinets must be pulled 3".
L/R refers to which side the blind is on.
Blind can be on the left or right.

tall cabinet specification

SKU	12 - 36" Wide Three Drawer Base Cabinets								
	Cabinet Box			Top Drawer Head			Top Drawer Box		
	W	H	D	W	H	D	W	H	D
DB12-3	12	34 1/2	24	11 1/2	6 3/4	7/8	8 1/2	4	21
DB15-3	15	34 1/2	24	14 1/2	6 3/4	7/8	11 1/2	4	21
DB18-3	18	34 1/2	24	17 1/2	6 3/4	7/8	14 1/2	4	21
DB21-3	21	34 1/2	24	20 1/2	6 3/4	7/8	17 1/2	4	21
DB24-3	24	34 1/2	24	23 1/2	6 3/4	7/8	20 1/2	4	21
DB30-3	30	34 1/2	24	29 1/2	6 3/4	7/8	26 1/2	4	21
DB36-3	36	34 1/2	24	35 1/2	6 3/4	7/8	32 1/2	4	21

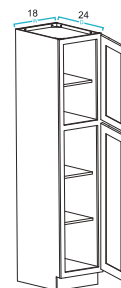
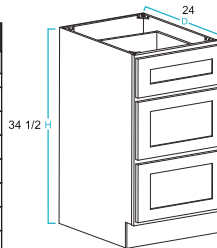

SKU	18" Wide Utility Cabinets					
	Cabinet Box			Top Doors		
	W	H	D	W	H	D
U188424	18	84	24	17 1/2	29	7/8
U189024	18	90	24	17 1/2	35	7/8
U189624	18	96	24	17 1/2	41	7/8

*Three adjustable shelves.

Bottom Doors		
W	H	D
17 1/2	49 1/4	7/8
17 1/2	49 1/4	7/8
17 1/2	49 1/4	7/8

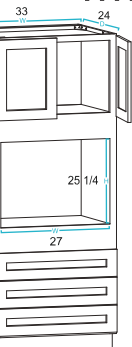

SKU	33" Wide Universal Oven Cabinets											
	Cabinet Box			Cabinet Doors			Drawer Head		Drawer Box			
	W	H	D	W	H	D	W	H	D			
O338424	33	84	24	16 1/4	11 1/2	7/8	32 1/2	8	7/8	29 1/2	5 1/8	21
O339024	33	90	24	16 1/4	17 1/2	7/8	32 1/2	8	7/8	29 1/2	5 1/8	21
O339624	33	96	24	16 1/4	23 1/2	7/8	32 1/2	8	7/8	29 1/2	5 1/8	21

*Opening is 27" x 25 1/4".
Drawers can be removed to accommodate larger ovens.
Fillers can be used to accommodate smaller ovens.

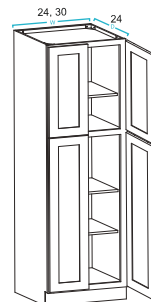

SKU	24/30" Wide Utility Cabinets					
	Cabinet Box			Top Doors		
	W	H	D	W	H	D
U248424	24	84	24	11 3/4	29	7/8
U249024	24	90	24	11 3/4	35	7/8
U249624	24	96	24	11 3/4	41	7/8
U308424	30	84	24	14 5/8	29	7/8
U309024	30	90	24	14 5/8	35	7/8
U309624	30	96	24	14 5/8	41	7/8

*Three adjustable shelves.

Bottom Doors		
W	H	D
11 3/4	49 1/4	7/8
11 3/4	49 1/4	7/8
11 3/4	49 1/4	7/8
14 5/8	49 1/4	7/8
14 5/8	49 1/4	7/8
14 5/8	49 1/4	7/8

accessory cabinet specification

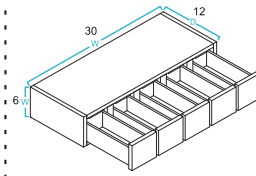

30" Wide Wall Spice Drawer Cabinet									
SKU	Cabinet Box			Drawer Heads			Drawer Boxes		
	W	H	D	W	H	D	W	H	D
WSD630	30	6	12	5 3/4	5 1/2	7/8	4 3/4	3 5/8	10

*Friction drawers, non soft close, no glides.

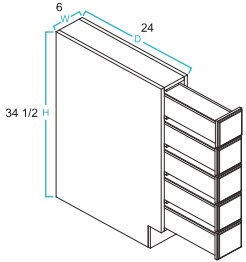

6" Wide Base Spice Drawer Cabinet									
SKU	Cabinet Box			Drawer Heads			Drawer Boxes		
	W	H	D	W	H	D	W	H	D
BSDC6	6	34 1/2	24	5 1/2	5 3/4	7/8	4 1/4	3 5/8	21

*Friction drawers, non soft close, no glides. Non nished sides.

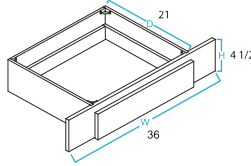

30 - 36" Wide Desk Drawer									
SKU	Cabinet Box			Drawer Head			Drawer Boxes		
	W	H	D	W	H	D	W	H	D
DSK30/36	36	4 1/2	21	29 1/2	3 3/4	7/8	26 1/2	2 1/8	21

*Can be trimmed from 30-36" wide.

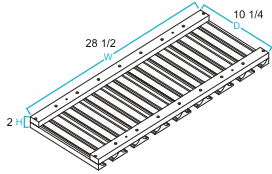

30" Wide Plate Rack Cabinet				
SKU	Dimensions			
	W	H	D	D
SGH30	28 1/2	2	10 1/4	

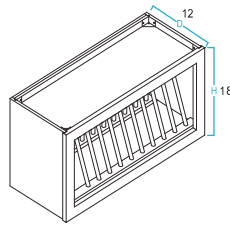

30" Wide Plate Rack Cabinet				
SKU	Dimensions			
	W	H	D	D
W3018PR	30	18	12	

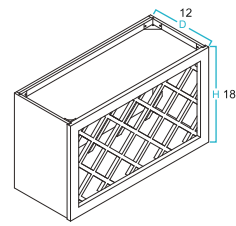

30" Wide Wine Rack Cabinet				
SKU	Dimensions			
	W	H	D	D
W3018WR	30	18	12	

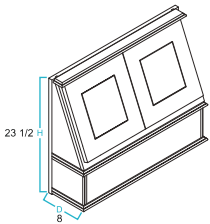

30 - 36" Wide Range Hood Cabinets			
SKU	Cabinet Box		
	W	H	D
RGH30	30	23 1/2	8
RGH36	36	23 1/2	8

*Mounts between two cabinets. Must use Convertible hood fan with T-Shape Hood Liner

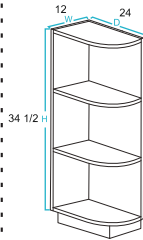

12" Wide Base End Shelf			
SKU	Cabinet Box		
	W	H	D
BES24-L	12	34 1/2	24
BES24-R	12	34 1/2	24

*Can be left or right.

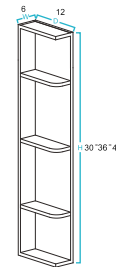

30 - 42" Tall Wall End Shelves			
SKU	Cabinet Box		
	W	H	D
WESR630	6	30	12
WESR636	6	36	12
WESR642	6	42	12

*Can be left or right.

Decorative Bun Feet - Classic/Fluted

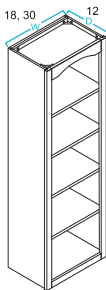
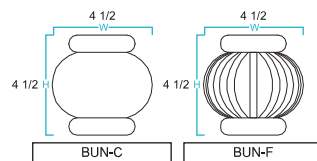

18 - 30" Wide Book Case Cabinets			
SKU	Cabinet Box		
	W	H	D
BC1848	18	48	12
BC1860	18	48	12
BC3048	30	60	12
BC3060	30	60	12

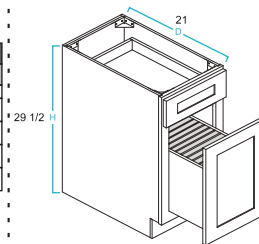

18" Wide Drawer File Base Cabinet									
SKU	Cabinet Box			Top Drawer Head			Top Drawer Box		
	W	H	D	W	H	D	W	H	D
DFB18-2	18	29 1/2	21	17 1/2	6 3/4	7/8	14 1/2	4	18
SKU	Bottom Drawer Heads			Bottom Drawer Boxes					
	W	H	D	W	H	D			
DFB18-2	17 1/2	17	7/8	14 1/2	13 3/4	18			

*Cabinets is 29 1/2" tall.

Filing cabinet separators not included.

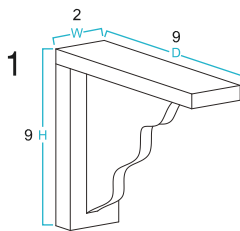
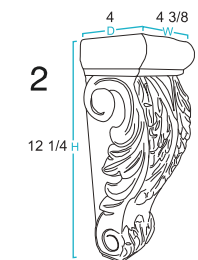

Decorative Corbels			
SKU	Dimensions		
	W	H	D
CB9	2	9	9
SKU	Dimensions		
	W	H	D
CBT	4 3/8	12 1/4	4

*Check availability

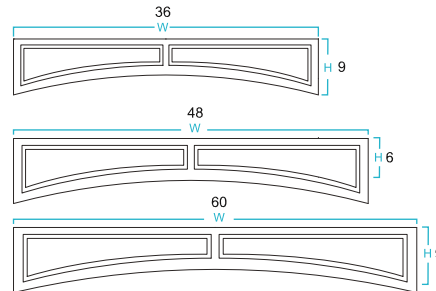

36 - 60" Wide Arched Valances	
VA36	
VA48	
VA60	

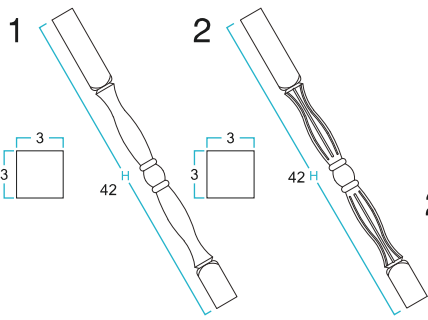

42" Tall Decorative Leg Posts - Classic/Fluted				
1	SKU	Dimensions		
		W	H	D
	PST-C	3	42	3
2	SKU	Dimensions		
		W	H	D
	PST-F	3	42	3

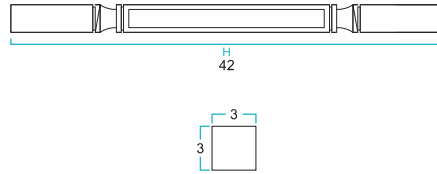

42" Tall Decorative Posts - Shaker				
	SKU	Dimensions		
		W	H	D
	PST-S	3	42	3

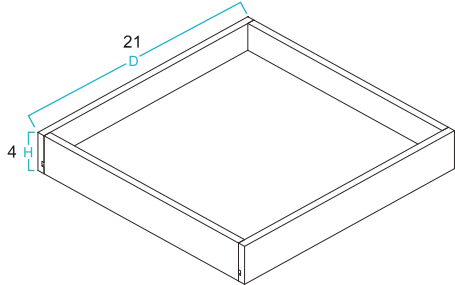

15 - 36" Roll Out Shelf Trays				
SKU	Dimensions			
	W	H	D	
RS15	11	4	21	
RS18	14	4	21	
RS21	17	4	21	
RS24	20	4	21	
RS27	23	4	21	
RS30	26	4	21	
RS33	29	4	21	
RS36	32	4	21	

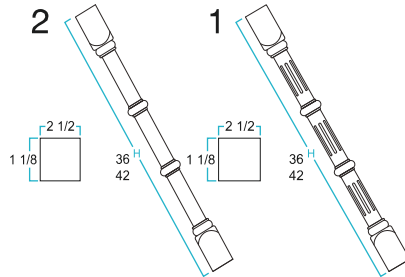

36 - 42" Tall Split Post Overlay Fillers - Classic/Fluted				
1	SKU	Dimensions		
		W	H	D
	SPST36-F	2 1/2	36	1 1/8
	SPST42-F	2 1/2	42	1 1/8
2	SKU	Dimensions		
		W	H	D
	SPST36-C	2 1/2	36	1 1/8
	SPST42-C	2 1/2	42	1 1/8

Scribe Molding SM8 *96" Length

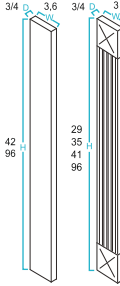
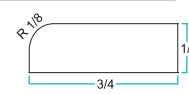

Batten Molding BM8 *96" Length

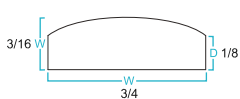

3 - 6" Wide Fillers - Regular/Fluted

SKU	Dimensions		
	W	H	D
F342	3	42	3/4
F642	6	42	3/4
F396	3	96	3/4
F696	6	96	3/4
FF330	3	29	3/4
FF336	3	35	3/4
FF342	3	41	3/4
FF396	3	95	3/4

*"FF" are fluted filler sizes.

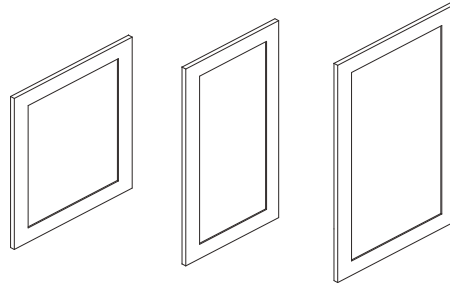

Decorative Door Panels

SKU	Dimensions		
	W	H	D
BDD24	23 1/2	30	3/4
WDD630	5 1/2	29	3/4
WDD30	11 1/2	29	3/4
WDD36	11 1/2	35	3/4
WDD42	11 1/2	41	3/4
UDD2430	23 1/2	29	7/8
UDD2436	23 1/2	35	7/8
UDD2442	23 1/2	41	7/8
UDD2449	23 1/2	49 1/4	7/8

trim
specification



*Charleston/York/Bristol Profile

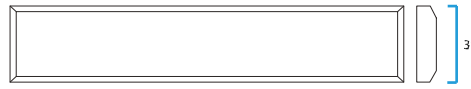

*Shaker Profile

3" Wide Overlay Wall Fillers

SKU	Dimensions		
	W	H	D
OWF330	3	29	3/4
OWF336	3	35	3/4
OWF342	3	41	3/4
OWF384	3	83	3/4
OWF390	3	89	3/4
OWF396	3	95	3/4

Toe Kick TK8 *96" Length

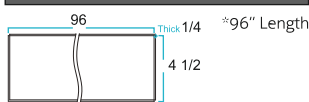

Angle Outside Corner Molding AOCM8 *96" Length

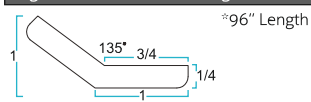

Outside Corner Molding OCM8 *96" Length



Inside Corner Molding ICM8 *96" Length

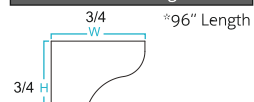

Quarter Round Molding QR8 *96" Length

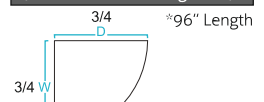

Light Rail Molding/Angle Light Rail Molding

LRM8/ALRM8

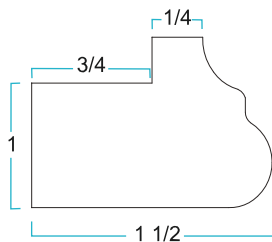

LRM8
*Charleston
York
Bristol

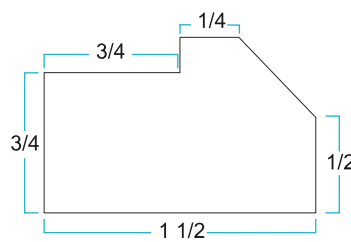

ALRM8
*Shaker

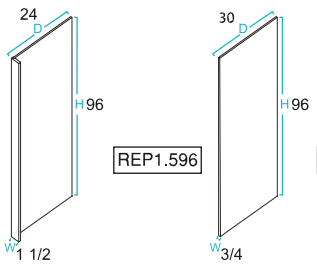
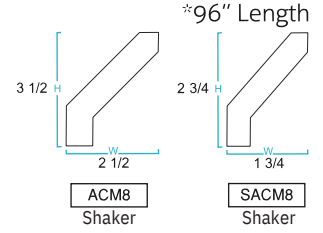
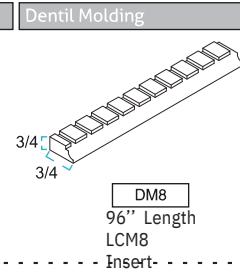
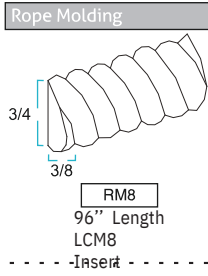
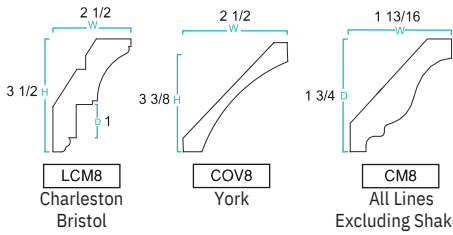

Refrigerator End Panels			
SKU	Dimensions		
	W	H	D
REP1.596	1.5	96	24
UREP96	3/4	96	30

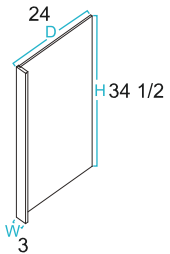

Dishwasher Return Panel			
SKU	Dimensions		
	W	H	D
DWR3	3	34 1/2	24

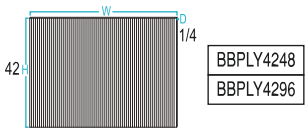
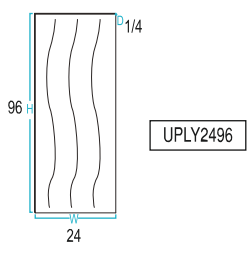
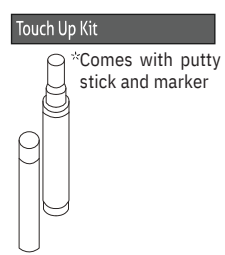
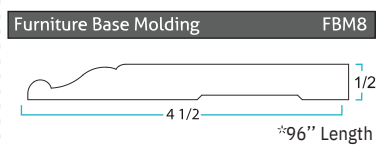

Finished Plywood Panels				SKU	Dimensions		
	W	H	D		W	H	D
	48	96	1/4	PLY4248	48	42	1/4
	96	96	1/4	PLY4296	96	42	1/4
	48	42	1/4	BBPLY4248	48	42	1/4
	96	42	1/4	BBPLY4296	96	42	1/4
	24	96	1/4	UPLY2496	24	96	1/4

vanity cabinet specification

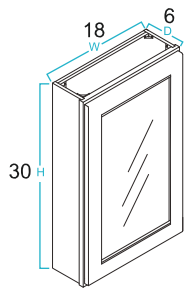

18 - 24" Wide Medicine Cabinets			
SKU	Dimensions		
	W	H	D
MC1830	18	30	6

*Glass not included.

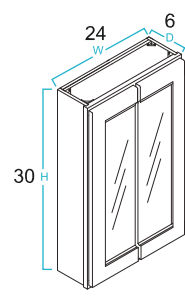

24 - 30" Wide Medicine Cabinets			
SKU	Dimensions		
	W	H	D
MC2430	24	30	6

*Glass not included.

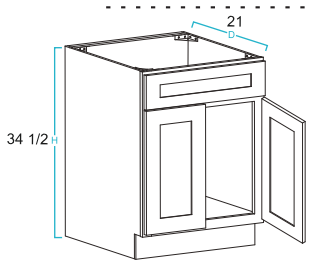

*Cabinet box is 21" deep.
L/R refers to which side drawers are on.

24 - 36" Wide Vanity Sink Base Cabinets										
SKU	Cabinet Box			Cabinet Doors			Drawer Head			
	W	H	D	W	H	D	W	H	D	
V2421	24	34 1/2	21	11 3/4	22	7/8	23 1/2	6 3/4	7/8	
V2721	27	34 1/2	21	13 3/4	22	7/8	26 1/2	6 3/4	7/8	
V3021	30	34 1/2	21	14 5/8	22	7/8	29 1/2	6 3/4	7/8	
V3621	36	34 1/2	21	17 3/4	22	7/8	35 1/2	6 3/4	7/8	

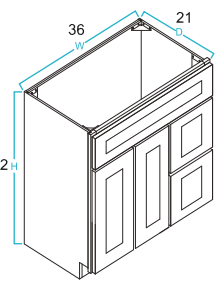
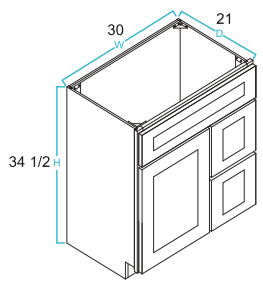

30 - 36" Wide Vanity Sink Base Drawer Cabinets												
SKU	Cabinet Doors			False Drawer Head			Operable Drawer Head			Drawer Box		
	W	H	D	W	H	D	W	H	D	W	H	D
V3021D-R	17 1/2	22	7/8	29 1/2	6 3/4	7/8	11 1/2	10 3/4	7/8	8 1/2	7	18
V3021D-L	17 1/2	22	7/8	29 1/2	6 3/4	7/8	11 1/2	10 3/4	7/8	8 1/2	7	18
V3621D-R	11 3/4	22	7/8	35 1/2	6 3/4	7/8	11 1/2	10 3/4	7/8	8 1/2	7	18
V3621D-L	11 3/4	22	7/8	35 1/2	6 3/4	7/8	11 1/2	10 3/4	7/8	8 1/2	7	18

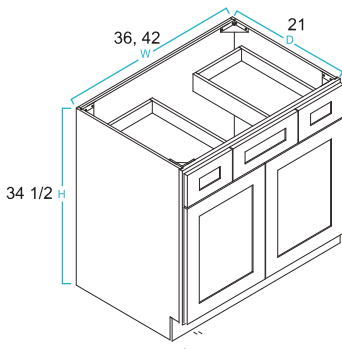

36 - 42" Wide Vanity Base Cabinets												
SKU	Cabinet Doors			False Drawer Head			Operable Drawer Head			Drawer Box		
	W	H	D	W	H	D	W	H	D	W	H	D
VB3621	17 5/8	22	7/8	16 1/2	6 3/4	7/8	9	6 3/4	7/8	6	4	18
VB4221	20 1/2	22	7/8	20 1/2	6 3/4	7/8	10	6 3/4	7/8	7	4	18

*Cabinet box is 21" deep.

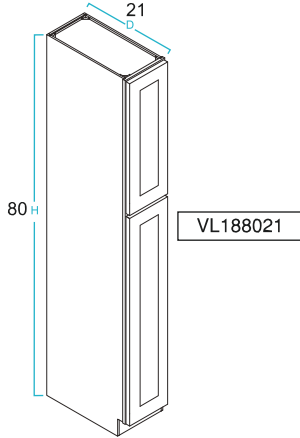

12 - 24" Wide Vanity Drawer Bases										
SKU	Cabinet Box			Top Drawer Head			Top Drawer Box			
	W	H	D	W	H	D	W	H	D	
VDB12-3	12	34 1/2	21	11 1/2	6 3/4	7/8	8 1/2	4	18	
VDB15-3	15	34 1/2	21	14 1/2	6 3/4	7/8	11 1/2	4	18	
VDB18-3	18	34 1/2	21	17 1/2	6 3/4	7/8	14 1/2	4	18	
VDB24-3	24	34 1/2	21	23 1/2	6 3/4	7/8	20 1/2	4	18	

*Bottom drawer heads are the same size.

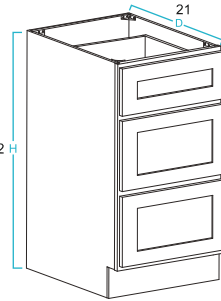

18" Wide Vanity Linen Cabinets									
SKU	Cabinet Box			Top Cabinet Door/Opening			Bottom Cabinet Door		
	W	H	D	W	H	D	W	H	D
VL188021	18	96	21	17 1/2	28 3/4	7/8	17 1/2	45 1/4	7/8

vent hood specification

ANGLE HOOD					
SKU	Dimensions				
	W	H	D	OW	OD
ANGLE HOOD	3	45 5/8	21 5/8	31 3/8	23
30" ANGLE	0 1/2	45 5/8	21 5/8	31 3/8	23

ARCH HOOD					
SKU	Dimensions				
	W	H	D	OW	OD
ARCH HOOD	3	45	21 5/8	31 3/8	23
30" ARCH	0	45	21 5/8	31 3/8	23

Only available in the following styles: Charleston Saddle - Charleston Linen - York Driftwood Grey - White Shaker Elite - Natural

6

6 5/8 21 5/8 9 1/4

ANGLE HOOD

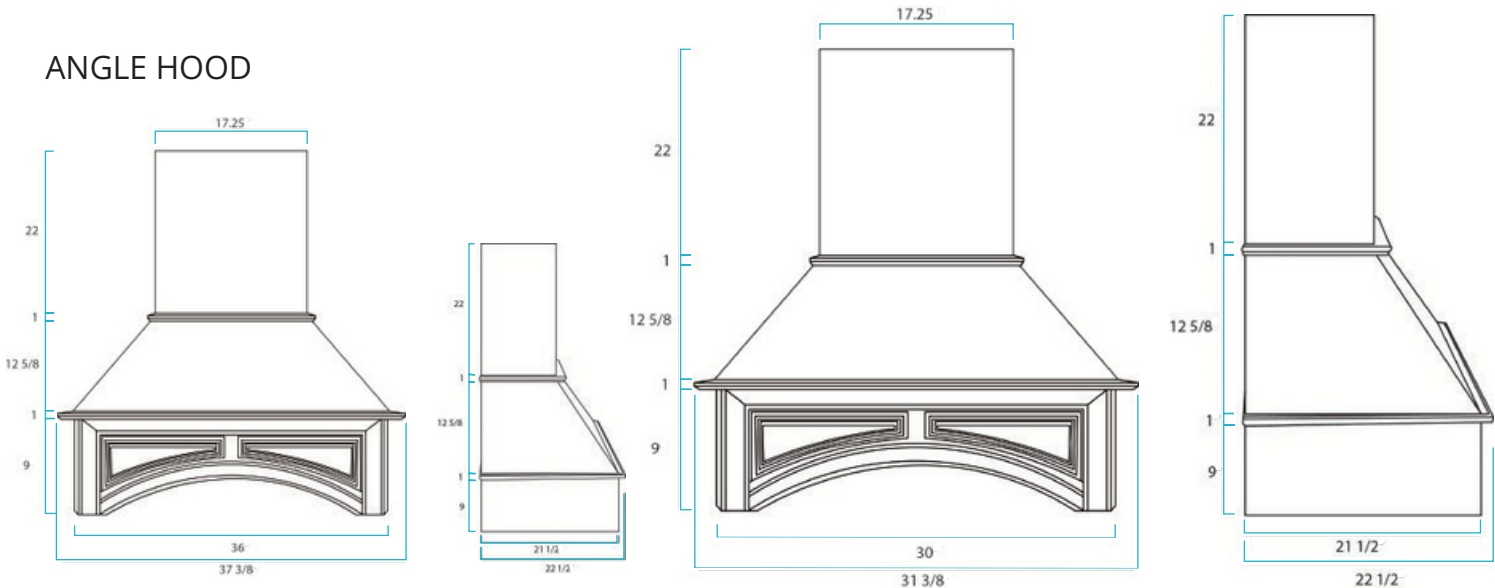

Only available in the following styles: Charleston Saddle - Charleston Linen - York Driftwood Grey - White Shaker Elite - Natural Un nished

ARCH HOOD

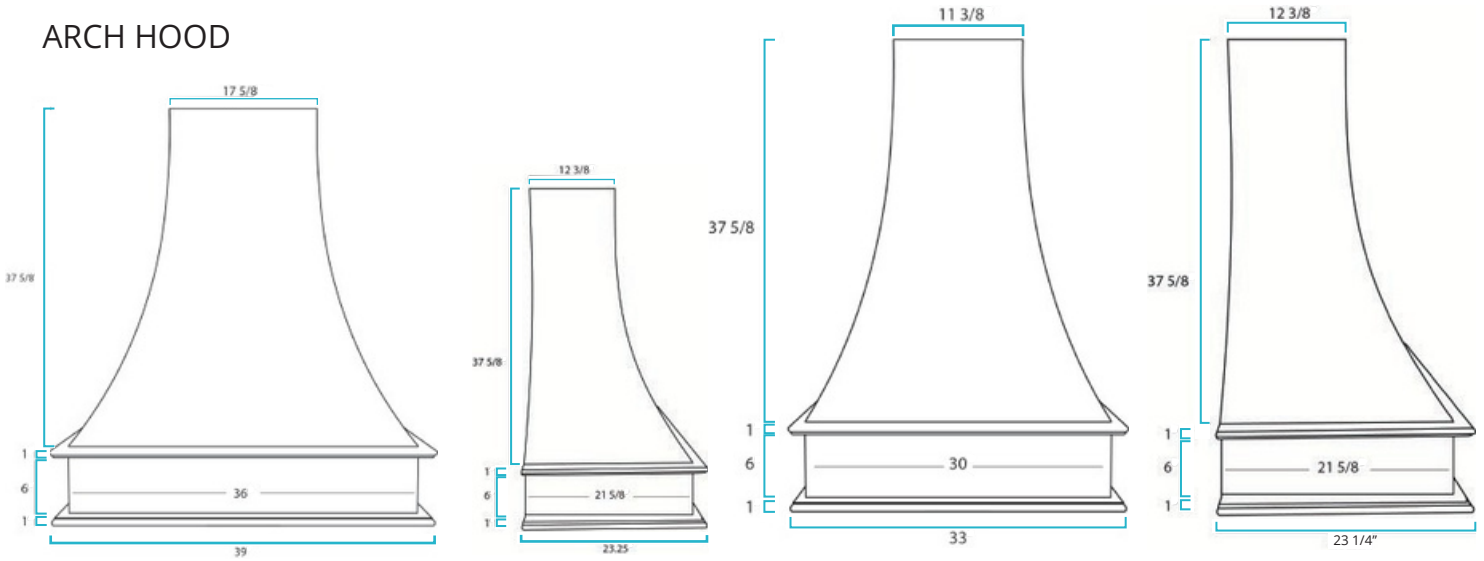

Only available in the following styles: Charleston Saddle - Charleston Linen - York Driftwood Grey - White Shaker Elite - Natural Un nished

SQUARE HOOD			
SKU	Dimensions		
	W	H	D
SQUARE HOOD	3	3	2
30 SQUARE HOOD	0	0	1
HOOD	36	3	2
SQUARE HOOD	6	0	1

Only available in the following 2 styles:
 Charleston Saddle - Charleston Linen - York
 Driftwood Grey
 White Shaker Elite - Natural Un nished

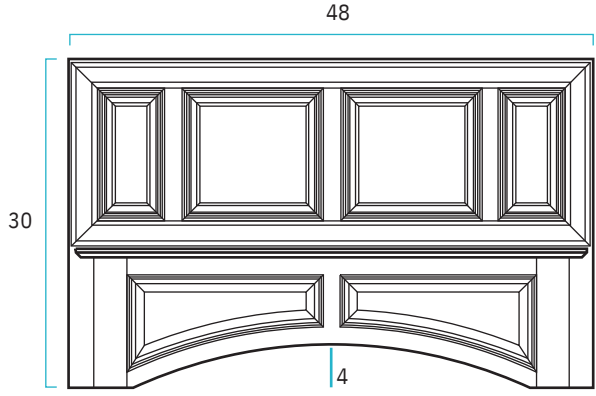
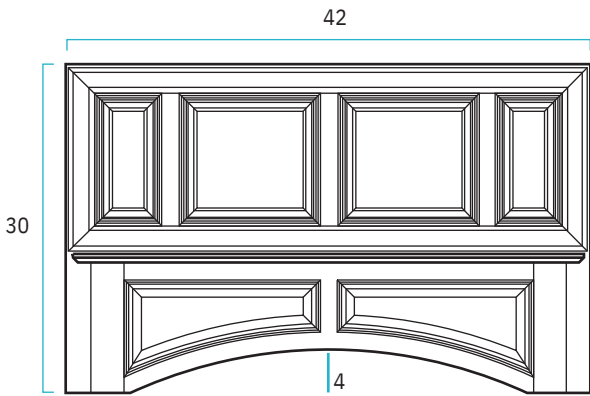
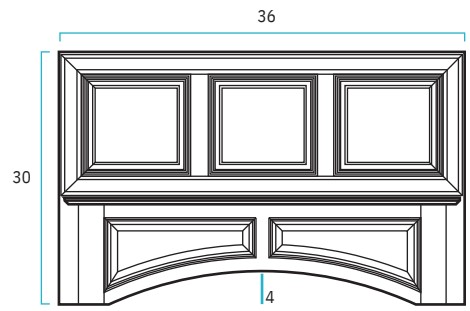
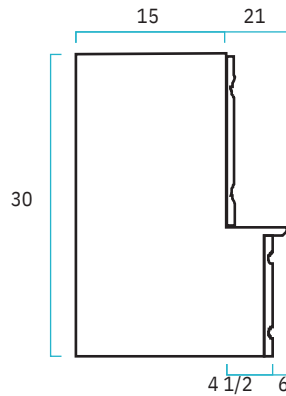

cabinet insert specification

BKSS			
SKU	Dimensions		
	W	H	D
B18KS	18	19 5/8	2 1/8

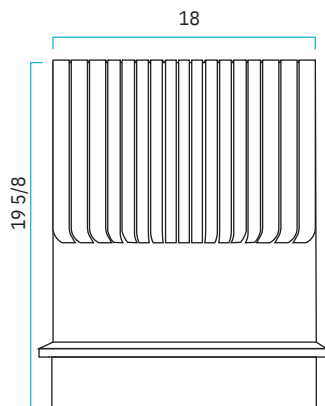

4DPS-30			
SKU	Dimensions		
	W	H	D
4DPS-30	25 1/5	19 5/8	1 1/2

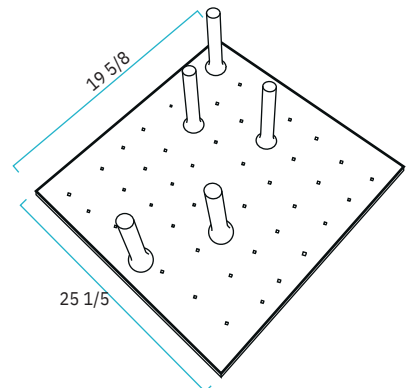

SRD			
SKU	Dimensions		
	W	H	D
SRD1	1	2	4
5	5	4	4

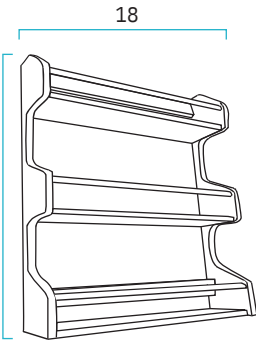
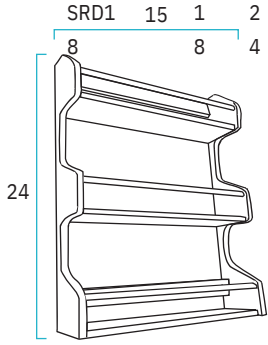

CDI			
SKU	Dimensions		
	W	H	D
CDI1	13	1/82	3/419
4	5/8	19	1/42

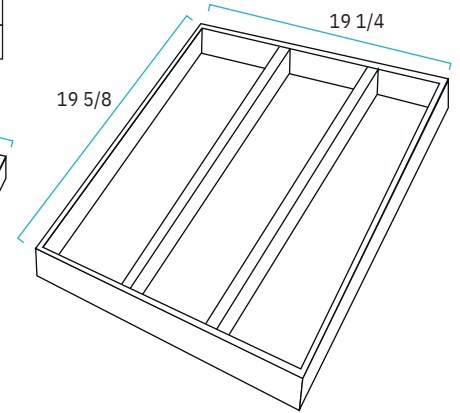
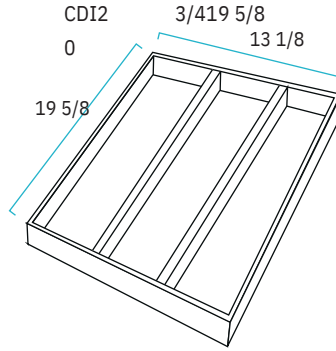

STI			
SKU	Dimensions		
	W	H	D
STI20	20	19 5/8	1 5/8

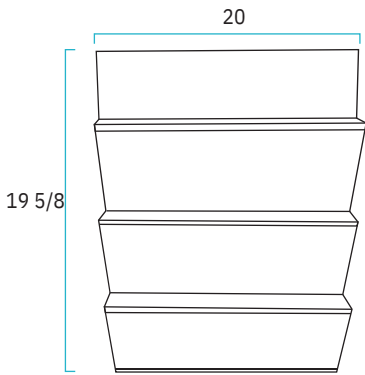

TCK			
SKU	Dimensions		
	W	H	D
TCK	14 5/8	12	21

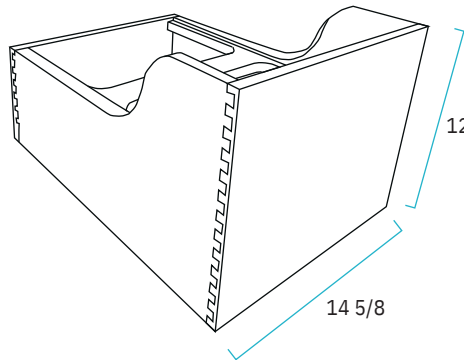

4WTCD			
SKU	Dimensions		
	W	H	D
4WTCD-	14	4	2
18	1/2	4	1

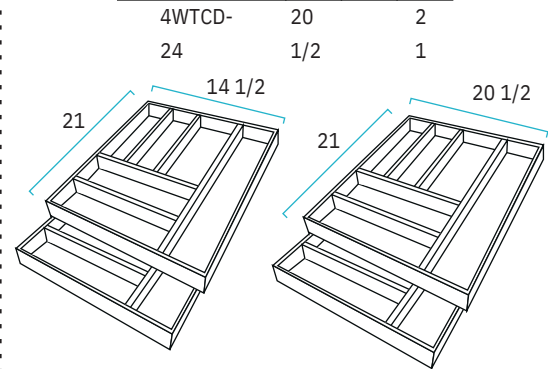

BUNDLE OF 2 BC-CADDY			
SKU	Dimensions		
	W	H	D
BC-CADDY	15 1/8	1 1/2	13 1/8
PULL OUT DRAWER BOX	2 3/8	1 3/20	1 1/2

*Only ts in BLB/42
Both items sold as a bundle. One sku for both parts.

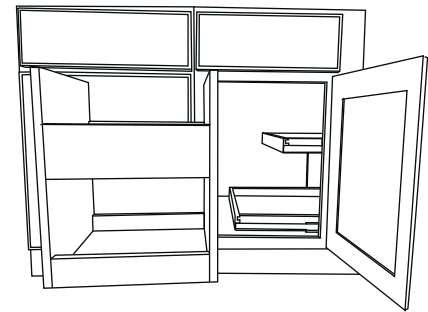
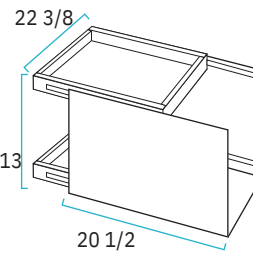
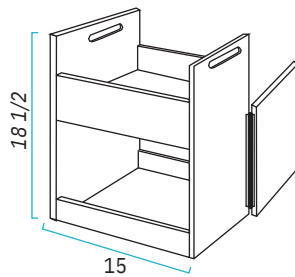

LST		
SKU	Dimensions	
	W	H
LST3	2	2
3	8	2

*Fits best in 33in cabinet

*Fits best in 36in cabinet

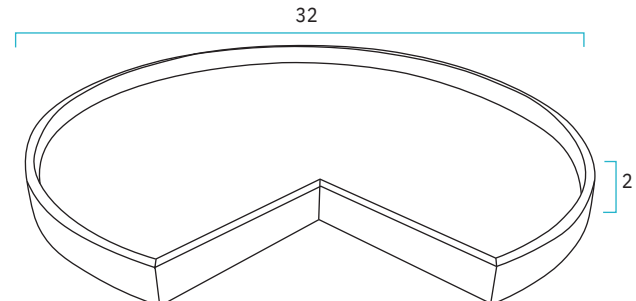
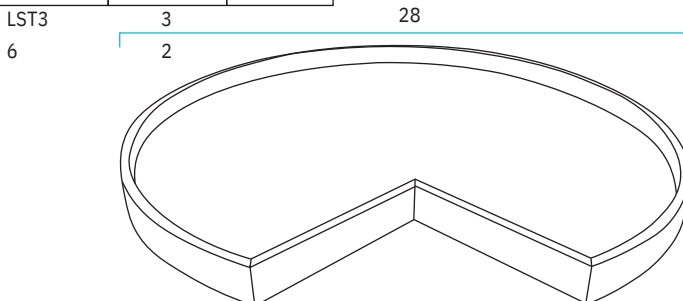

POLST		
SKU	Dimensions	
	W	H
POLST	3	4
33	2	4
POLST	3	
36	5	

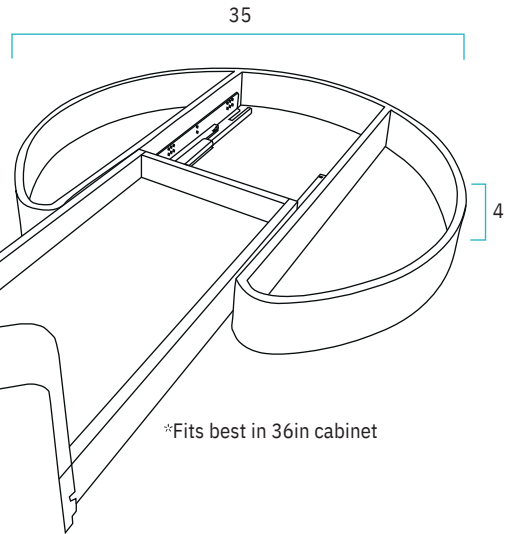
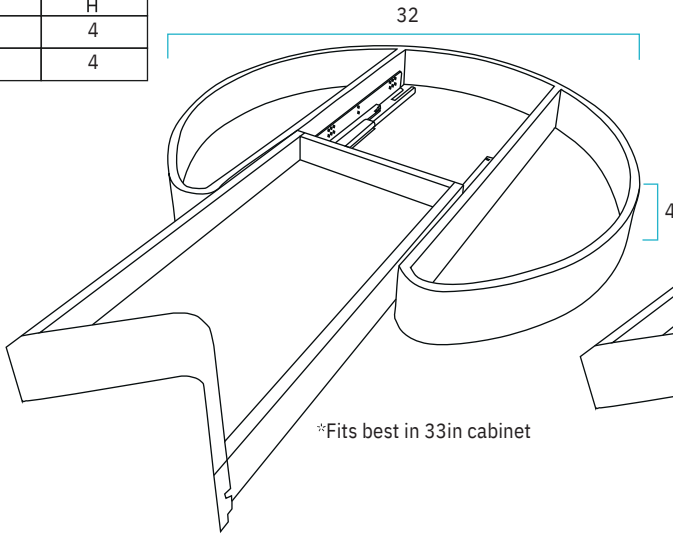

floating shelf specification

SQUARE BODY			
SKU	Dimensions		
	W	H	D
FLOATING SHELF	24	4	1/2
FLOATING SHELF	30	6	1/2
FLOATING SHELF	36	2	1/2
FLOATING SHELF	42	8	1/2
FLOATING SHELF	48	8	1/2

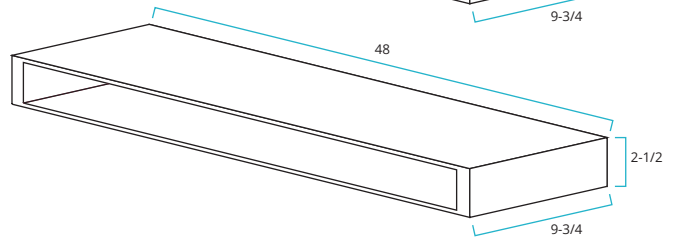
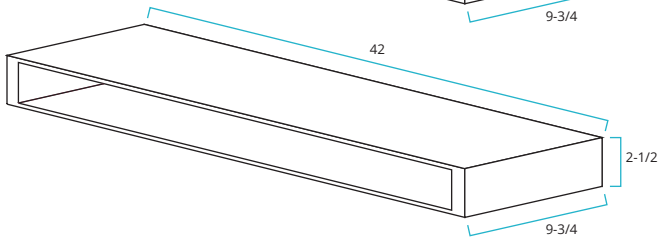
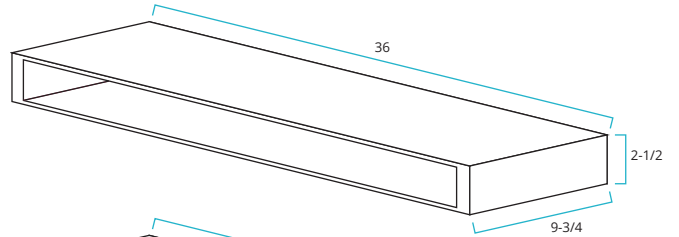
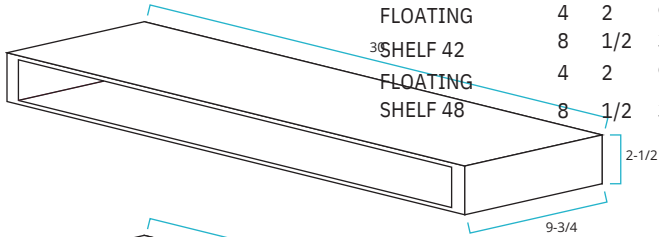
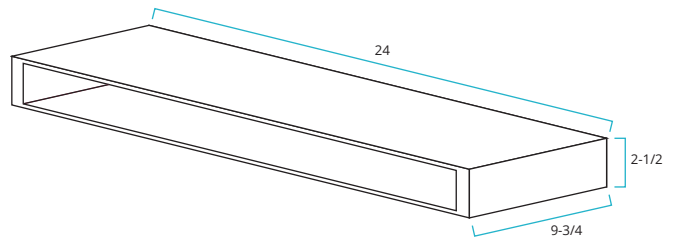

cabinet lighting specification

POWER SUPPLY			
SKU	Dimensions		
	W	H	D
WF-LED-PSU-JCT-103	3 1/4	1 1/4	3
WF-LED-PSU-2	3/8	1	3/4

WF-LED-PSU WF-LED-PSU-MT-10



CABLE CONNECTION	
SKU	Dimensions
WF-	L
WF-	5
LT50020-5	8
WF-	1
LT50020-8	1
WF-	1
LT50020-11	4
WF-	1
LT50020-14	7
WF-	2
LT50020-17	0
WF-	2
LT50020-20	3
WF-	2
LT50020-23	6
WF-	2
LT50020-26	9
WF-	3
LT50020-29	2
WF-	3
LT50020-32	3
WF-	5
LT50020-35	7
WF-LT0808-	2
WF-LT0808-	3

WF-LT50020

LED Lights available in the following lengths

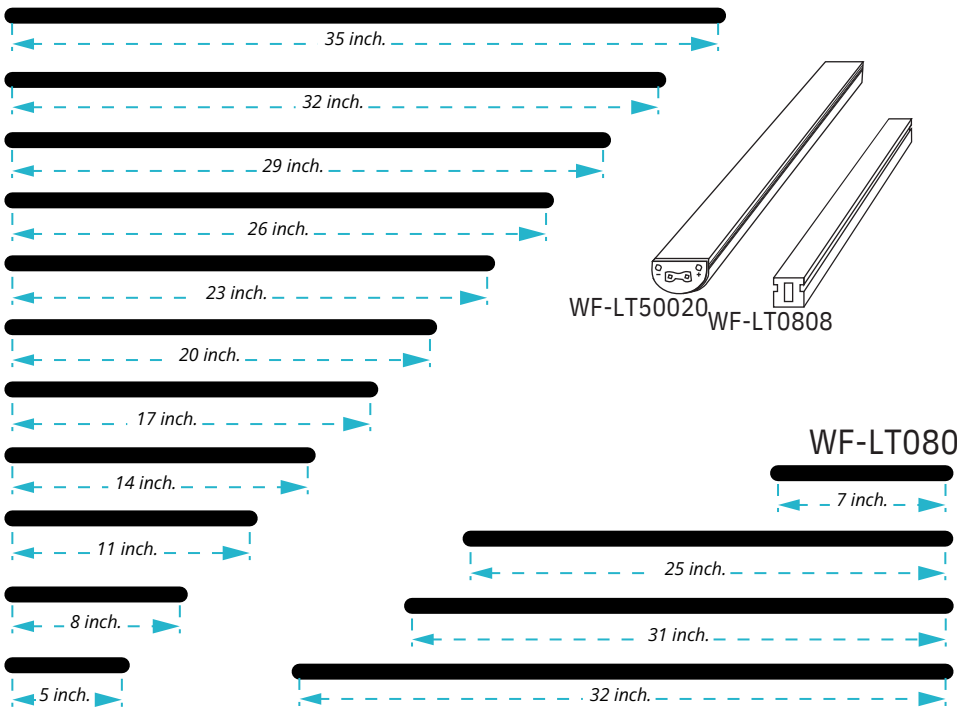

WIRELESS	
SKU	Dimensions
WF-LT0808-	L
WF-LT0808-	3
WF-LT50020-ICC-12	12
WF-LT50020-ICC-40	40
WF-LT50020-ICC-120	12
WF-LT0808-ICC-60	0
WF-LT0808-ICC-120	60
WF-LT50020-PC-60	12
WF-LT50020-PC-120	0



WF-LT50020-
ICC-12 WF-
LT0808-ICC-120

WF-LT50020-
ICC-40 WF-
LT50020-PC-60

WF-LT50020-
ICC-120 WF-
LT50020-PC-120

WF-LT0808-ICC-60



WF-LT50020

CONNECTING WIRES

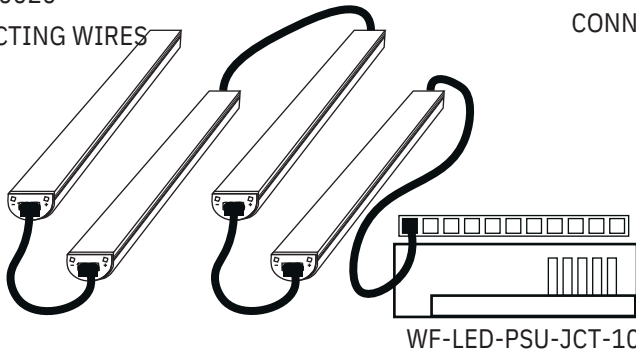

WF-LT0808

CONNECTING WIRES

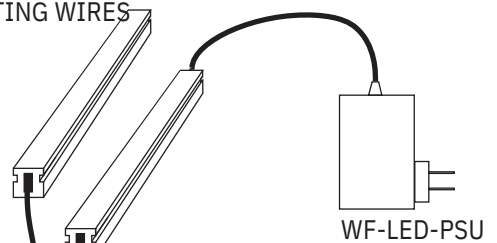



Quality
Cabinetry